

Gillings School Facilities



GILLINGS SCHOOL OF
GLOBAL PUBLIC HEALTH

Facilities Team

- Brent Wishart

- *Senior Director of Facilities*
- 205 Rosenau
- Capital Projects
- Space Planning
- Renovations



- Brent.Wishart@unc.edu

Facilities Team

- Julie McManus



- *Facilities Coordinator*
- 204 Rosenau
- Room reservations
- One Card access
- Event Planning
- Building maintenance coordination
- Parking Coordinator for CAU

- Julie.McManus@unc.edu

Facilities Team

- David King



- *Facilities Assistant*
- 204 Rosenau
- Grounds
- Lost and Found
- Event support
- Classroom setup

- David.King@unc.edu

Facilities Team

- **William White**

- *Facilities Support Assistant*
- 204 Rosenau
- Classroom setup
- Event support
- Mail distribution
- On-site Mondays and Fridays

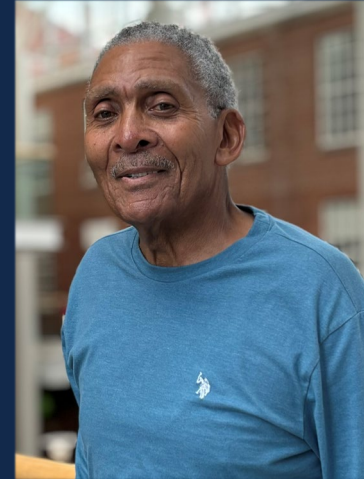

- wwhite@unc.edu

- DPS Security Guards
 - On duty 24/7
 - Can reach at (919) 357-8037
 - Stationed in MHRC atrium



- AED in each building lobby area
- Narcan located in MHRC mailroom
- Masks available in each building
- Classrooms and conference rooms are all lockable from inside with window covers

SEVERE WEATHER SHELTERS AT GILLINGS

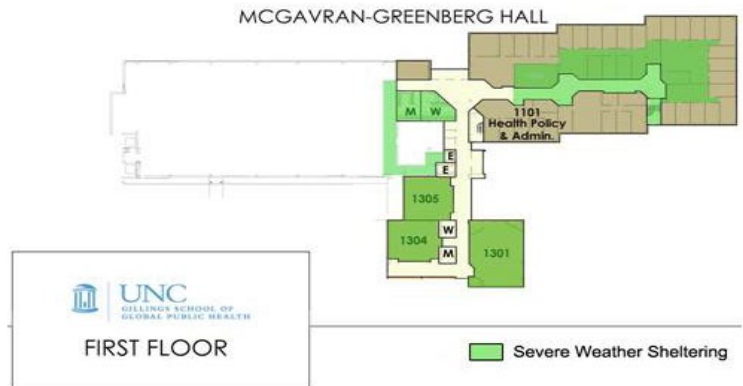

<https://sph.unc.edu/emergency-information/>

- One Card access
- Spaces open 7am-7pm
- Day lockers in Rosenau by 230

- Classrooms
- MHRC Armfield Atrium
- 201 Rosenau – CCI Printers
- Outdoor seating

- Lactation Room by Rosenau 228
- Quiet Room Rosenau 016
- Hoteling Offices Rosenau 004
- Showers in Rosenau ground floor

- SPH_FACILITIES@UNC.EDU
- sph.unc.edu/staff-contact-information/
- Reach out anytime!